

FABLICATOR

MX Series Additive Manufacturing Workstation

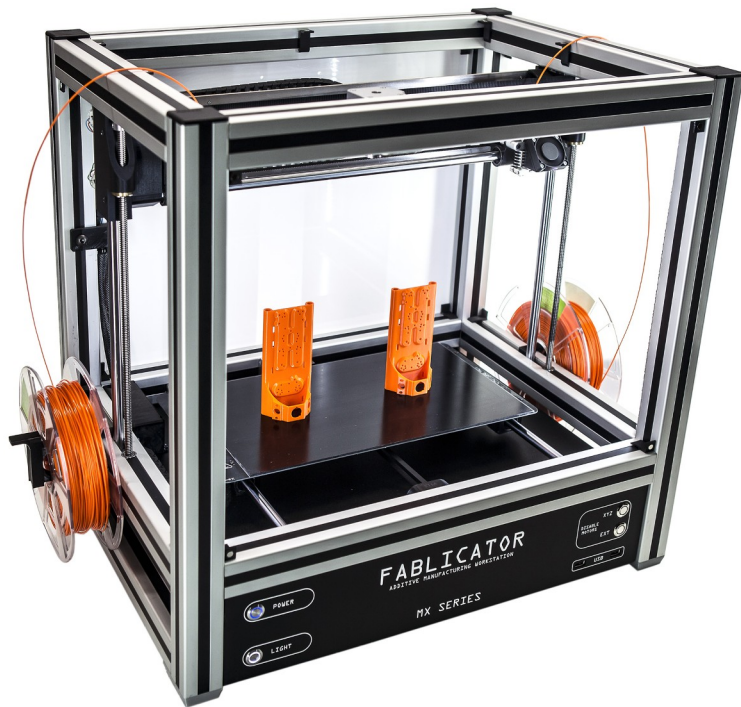

Commercial Grade Additive Manufacturing Workstation For Industry and Education

Not your Average 3D Printer!

The Fablicator MX is unlike any other 3D Printer on the market.

It is a complete 3D Printing Workstation, capable of designing (when CAD is installed), slicing and printing 3D models without needing a separate computer. It is a complete 3D printing solution for schools, offices, laboratories and factories alike.

The MX ships completely assembled, tested and calibrated. It is ready to make fast, accurate parts right out of the box.

The Fablicator MX features a unique independent dual extruder system, capable of making parts using different materials or support materials, while maintaining exceptional part quality.

No Assembly Required or Software to Install

The Fablicator MX is supplied with a fully integrated Microsoft Windows 10 or 11 64 bit Pro computer with all of the software pre-installed and settings established to begin printing right away. All you need to start making parts is to plug in a mouse, keyboard, monitor and have a 3D model of what you wish to print.

Fablicator Interface

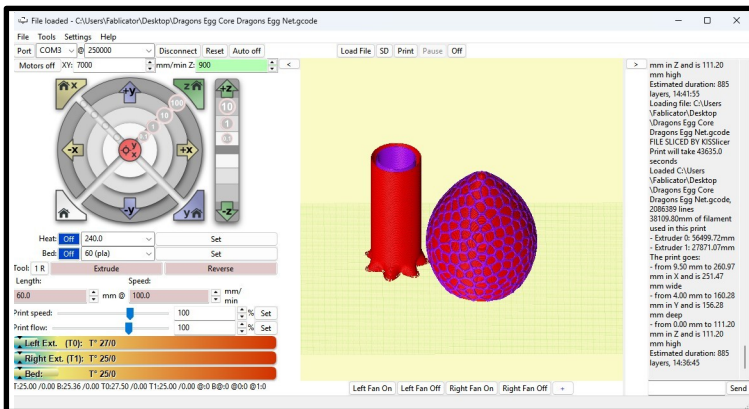

Cura

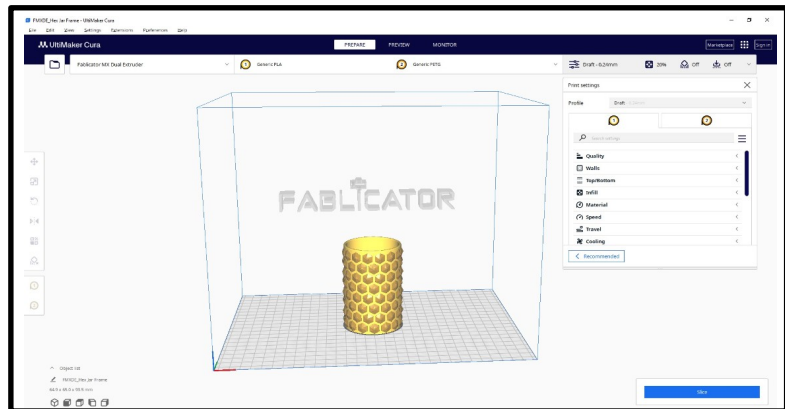

KISSlicer

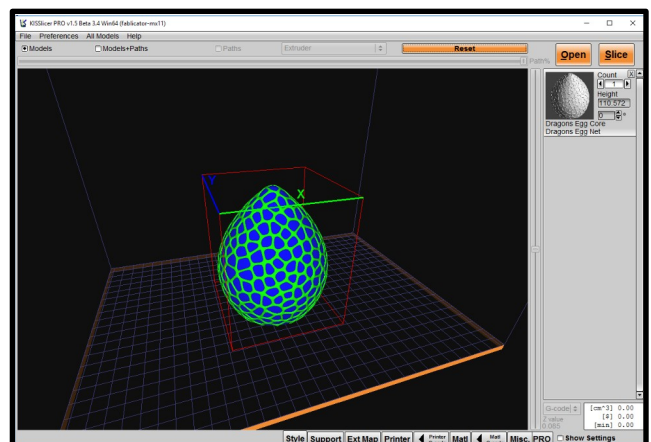

Designed and Manufactured in USA



Find Your Authorized
Distributor

FABLICATOR

MX Series Product Features

Technical Specifications

Printing

Printer Type
FFF (Fused Filament Fabrication)

Number of Extruders
Dual Independent

Maximum Build Size
13.5 L x 8.5 W x 9.5in H in
[343 L x 216 W x 241 H mm]

Addition Features
Part Cooling Fan
Filament Out Sensor

Filament Diameter
1.75mm

Usable Materials

ABS
PLA
PLA-PHA
PET
Semiflex TPU
Antistatic ABS
Antistatic PET
Woodfill
HIPS

Nozzle
.35mm
Stainless Steel Core

Workspace Illumination
LED

Size and Weight

Printer Dimensions
With filament
31.5 L x 18 W x 23 H in
[800 L x 457 W x 584 H] mm

Without Filament
23.125 L x 18 W x 23 H
[588 L x 457 W x 584 H mm]

Shipping Weight
78lb [31kg]

Printer Weight
65lbs [30kg]

Mechanical

Frame
4040 Aluminum Extrusion
12mm linear rails

Build Surface
Chemically strengthened and
textured glass

Calibration
Factory calibrated

Mechanical Precision
0.00035in [10micron] or better

Integrated Computer

Software
Windows 10 or 11 64 bit PRO

SolidWorks, Fusion360, Inventor,
and TinkerCAD capable

Hardware
Intel Core i5 6500
16gb ram
500gb HDD
650W power supply
Dual front USB ports

Printing Software

Slicing
Cura
KISSlicer 64 bit

Interface:
Fablicator Interface

File type
.STL, G-Code

File import
USB, WiFi, Ethernet

Electrical

Power
100-240V
6A max, 2A typical

Four Print Modes

Multi-Color Mode

Print with two different colors.

Makes prints look stunning and enables a high level of artistic creativity



Support Material Mode

Creates supports using a dissolvable or easy to remove support material

Great for complex parts not designed Specifically for 3D Printing



Copy Mode

Each head prints a copy of a part Simultaneously

Perfect for producing a large quantity of simple parts quickly



Single Extruder Mode

Only use one extruder to print a single material part

Largest build area and extremely simple settings selection.



Textured and heated glass print surface



Parts adhere well while printing and remove easily

Exceptional flatness, and holds calibration between prints.

Resists solvents and scratches

Evenly heated

Parts print directly on the surface with a primer, no tape or rafts needed.

Large maximum printable area

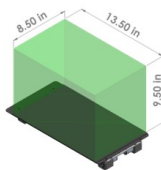

Larger than a sheet of paper

Multi-Color Mode 13 x 8.5 x 9.5
Support Material Mode 13 x 8.5 x 9.5
Copy Mode (each half) 7 x 8.5 x 9.5
Single Material Mode 13.5 x 8.5 x 9.5

All metal extruders

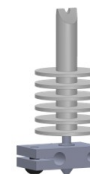

No Plastic Parts
No Leaks

Build around a stainless steel core press fit onto an aluminum heater block and heat sink

Tough and Rigid

Industrial aluminum frame

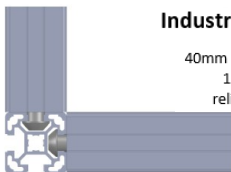

40mm aluminum extrusions and 12mm linear rails for reliability and precision.

Integrated Windows 10 or 11 64bit PC

Design and Print from one place



Can run SolidWorks, Inventor, Blender, TinkerCAD, or any other CAD program directly from the printer.

Interface with the printer directly using a monitor, keyboard and mouse

Easy to maintain



Low maintenance and user replaceable parts

Easily replace components should the unexpected happen

Material Versatility

ABS	PLA
PET	PVA
SemiFlex TPE	PLA-PHA
Anti-Static PET	HIPS

No Proprietary Filament

The variety of available filament if ever expanding, and we don't want to limit innovation by only allowing our own filament to be used.

More than 12 colors of ABS, PLA, and PET are available directly from Fablicator

Filament Out Sensor



Pauses your print before filament runs out.

Never worry about your print being ruined by filament a spool running out.

Part Cooling Fan

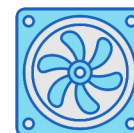

Provides superior print results through reduced warping.

Variable speed which can be tuned to match filament requirements.